

# CHDD Series - Sanitary Gas Filter Housings



Sanitary Gas Filter Housings are suitable for removal of particulate from gas streams. When used with appropriate sterilizing-grade filter cartridges, the combination can be used in high-purity sterile gas filtration.

## Features

- Ultra-fine polishing: Internal:  $Ra \leq 0.3\mu m$ ; External:  $Ra \leq 0.4\mu m$
- Accepts 226-style cartridges with locking tabs to assure safe and secure sealing performance.
- The Tri-Clamp body connection allows easy servicing and cartridge change-out.
- Compatible with cartridge connection for 222 and 226, the housing is applied in high-purity, high-temperature, aseptic, fermentation, etc.

## Surface Finish

Finish Processing Options: Electropolished  
Mech. Polished

Polish Quality: Internal:  $Ra \leq 0.3\mu m$   
External:  $Ra \leq 0.4\mu m$

## Operating Conditions

Max. Operating Pressure: 0.6MPa (90psi, Tri-clamp)  
Max. Operating Temperature: 1.0MPa (150psi, Flange)  
140°C (284°F)

## Materials

Shell Options: 304 or 316L Stainless Steel

Drain Port: 304 or 316L

Tri-clamp: 304

Stabilizer Blade: 304

Seal Materials: Silicone, FKM, EPDM

## Connection

Shell Connection: Tri-clamp or Flange

Inlet & Outlet (N1, N2): 1", 1.5" Tri-clamp or DN25/  
DN50 Flange (PL-RF, HG/  
T20592-2009 PN16)

Pressure Gauge Port (N3): M14\*1.5 Thread FNP-

Drain Port (N4): T1/4" Thread

## Applications

- Pharmaceuticals: gas sterilization and air/gas filtration in the production of biological products
- Food and beverage: gas sterilization and air/gas filtration in the production of food, beverages, and fermented products
- Chemical industry: filtration of industrial gases such as coal gas, hydrogen, nitrogen, and natural gas, among others
- Laboratory: environmental air filtration

Eg. => CHDDQJ0110T25SEFY

ORDERING INFORMATION									
Series	Connection	Shell Material	Qty.	Length	Inlet&Outlet	Seal Material	Surface Finish (internal)	Surface Finish (external)	Design Pressure
CHDD=Sanitary	Q = 226 / Fin	J=304	01=1	05= 5"	T25=TC 1"	S=Silicone	E=Electropolished	E=Electropolished	Y=1.0Mpa
Gas Filter Housing	P = 222 / Fin	K=316L		10 = 10"	T38=TC1.5"	E=EPDM	M=Mech. Polished	M=Mech. Polished	
	T = 226 / Flat			20 = 20"	F25=Flange DN25	V=FKM			
	M = 222 / Flat			30 = 30"	F50=Flange DN50				
				40 = 40"					

# Dimensions (mm)

## Flange Type

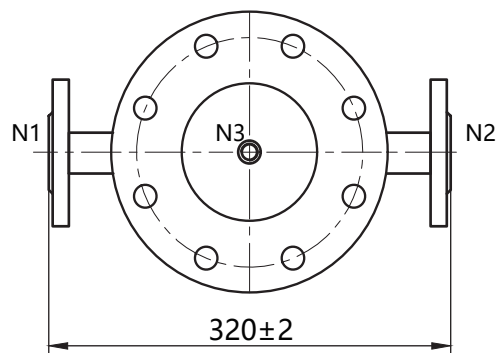
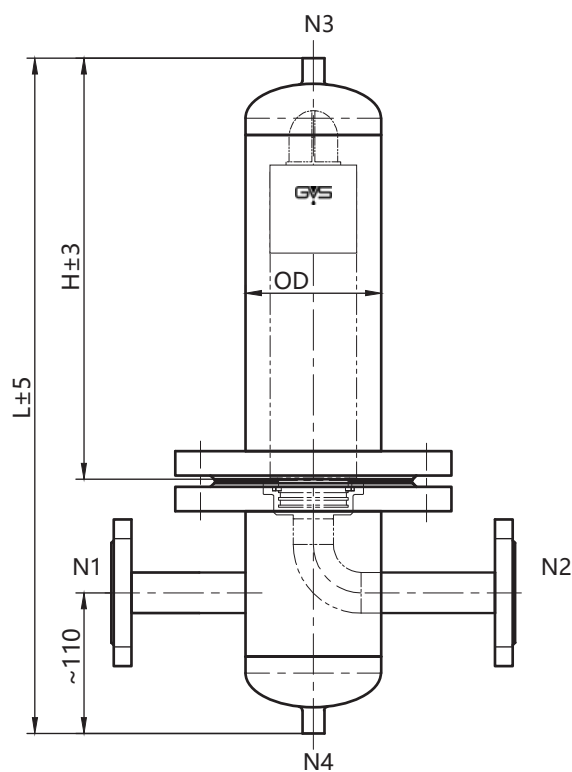

Housing Cartridge height(mm) length	H	L
5"	210	410
10"	340	540
20"	590	790
30"	840	1,040
40"	1,090	1,290

## Tri-clamp Type

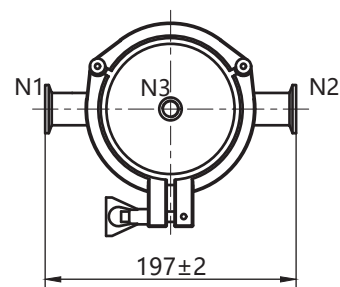
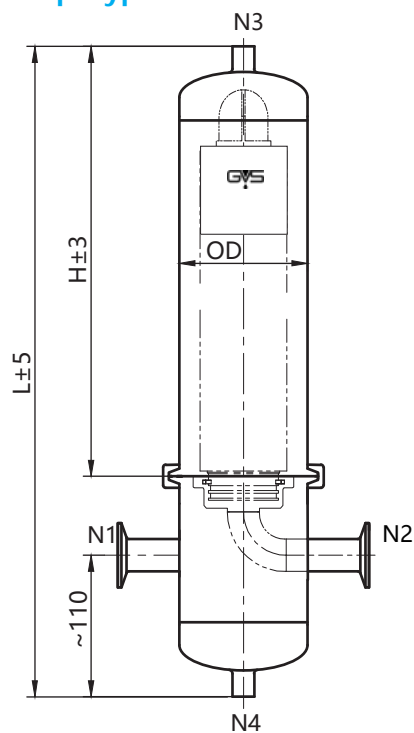

Housing Cartridge height(mm) length	H	L
5"	208	380
10"	338	510
20"	588	760
30"	838	1,010
40"	1,088	1,260