

CHDH Series - Sanitary Depth-Stack Filter Housings



Sanitary Depth-Stack Filter Housings are a new type of depth-stack filter housing. Designed to meet requirements for sanitary construction with smooth crevice-free welding and TC-type sanitary connections. Easy to clean and disassemble. The co-linear inlet and outlet flow paths beneath the vessel shell serve to minimize liquid turbulence. Available for 8", 12" and 16" diameter cartridges up to four high modules to meet high flow rates requirements.

Features

- Ultra-high degree of polishing: Internal: $Ra \leq 0.3\mu m$; External: $Ra \leq 0.4\mu m$
- Liquid turbulence is minimized with co-linear inlet-outlet porting beneath the housing shell.
- Specially designed drain valves can optionally be installed on the inlet and outlet ports for easy liquid drainage.
- Allows vertical stacking of up to four depth-stack cartridges and provides high flow rates at high retention efficiency.
- Segmented cartridge design makes it more convenient to replace depth stack cartridges and helps to reduce liquid loss.
- The housing is fitted with DOE and stack with support plates part or handle, 3 modules for 8" and 4 modules for 12" and 16".
- Optional N6 drain port (Sampling port).

Surface Finish

| | |
|----------------------------|--|
| Finish Processing Options: | Electropolished Mech. Polished |
| Polish Quality: | Internal: $Ra \leq 0.3\mu m$ External: $Ra \leq 0.4\mu m$ |

Operating Conditions

| | |
|----------------------------|----------------------|
| Max. Operating Pressure: | 1.0MPa (10bar150psi) |
| Max.Operating Temperature: | 80°C(176°F) |

Materials

| | |
|-----------------|-----------------------------|
| Shell Options: | 304 or 316L Stainless Steel |
| Vent Port: | 304 or 316L |
| Eyebolts: | 304 |
| Legs: | 304 |
| Seal Materials: | Silicone, FKM, EPDM |

Connection

| | |
|---|--|
| Shell Connection: Inlet & Outlet (N1,N2): | Eyebolt Tri-clamp |
| Vent Port(N4): | Sanitary hose barb valve fit with integrity test interface |
| Drain Port (N5, N6): | Sanitary hose barb valve for 8mm i.D. tubing |
| Pressure Gauge (N3): | 1.5" TC |

Applications

- Pharmaceuticals: filtration of injectables, LVPs, water for injection, and other biological products
- Food and beverage: filtration of beer, wine, and distilled spirits, juices, syrups, and edible oils
- Chemical industry: filtration of grease and dirt, sludge, and gelatinous materials

Cartridge Sealing System

A spring-loaded sealing system provides optimal sealing compression to help prevent filter bypass even under the most arduous process conditions.



Carriflow

Dimensions (mm)

8"

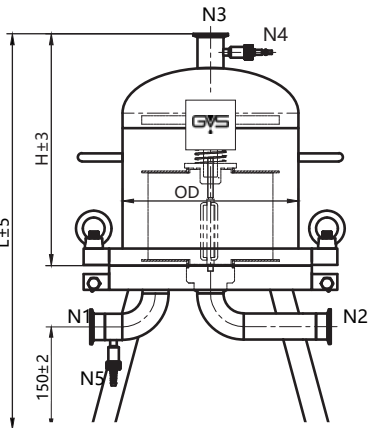

Type A (N6-free)

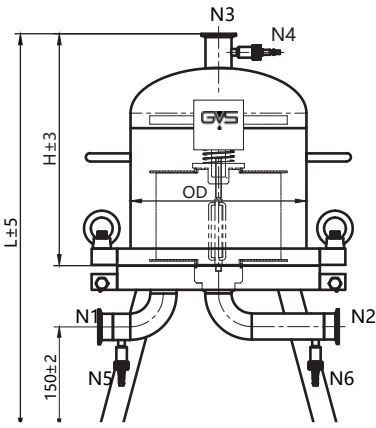

Type B

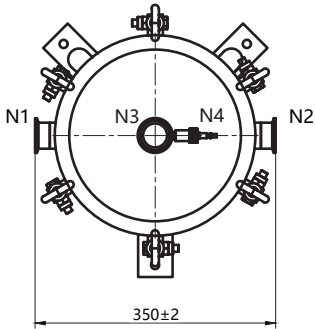

| Housing Cartridge height(mm) length | H | L |
|---|-----|-----|
| 8 | 337 | 572 |
| 16 | 477 | 712 |
| 24 | 617 | 852 |

12"

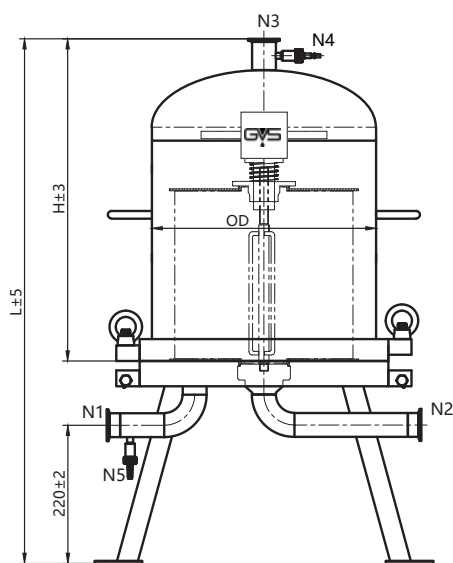

Type A (N6-free)

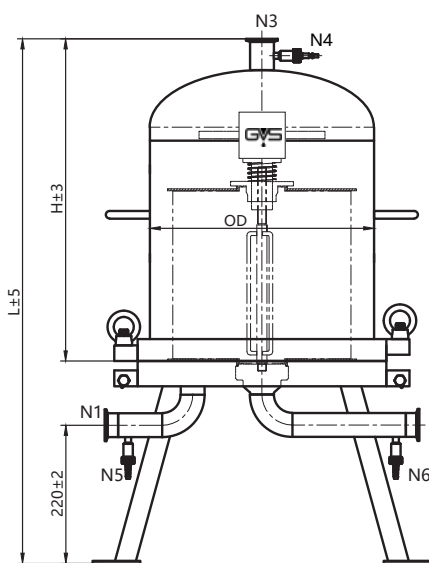

Type B

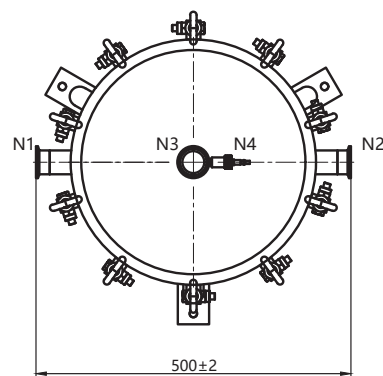

| Housing Cartridge height(mm) length | H | L |
|---|-------|-------|
| 16 | 512 | 825 |
| 32 | 792 | 1,105 |
| 48 | 1,072 | 1,385 |
| 64 | 1,352 | 1,665 |

16"

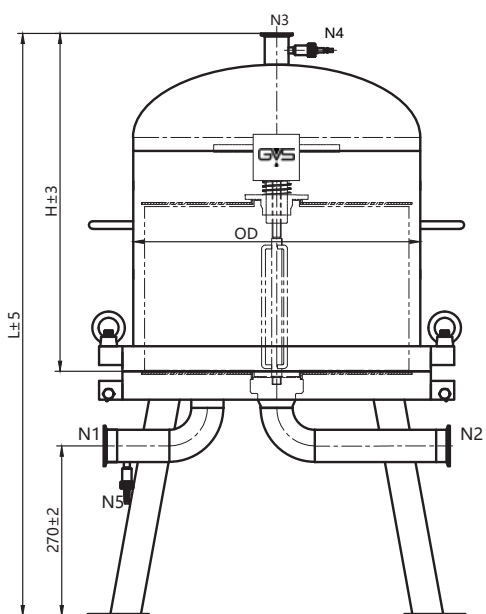

Type A (N6-free)

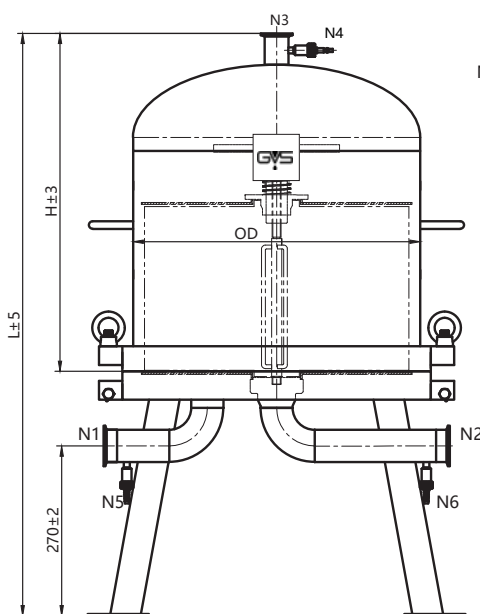

Type B

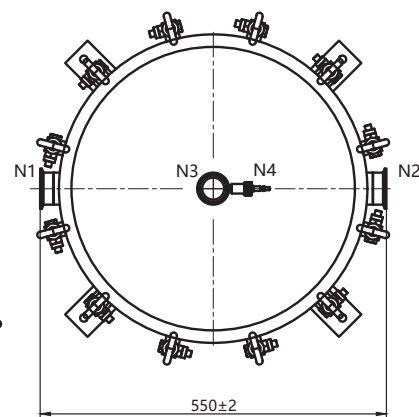

| Housing Cartridge height(mm) length | H | L |
|---|-------|-------|
| 16 | 537 | 915 |
| 32 | 817 | 1,195 |
| 48 | 1,097 | 1,475 |
| 64 | 1,377 | 1,755 |

Eg.=>CHDHAFJ0801T38SEY

| ORDERING INFORMATION | | | | | | | | |
|-------------------------|------------|----------|------------------|------------------------|---------------|---------------------------|---------------------------|-----------------|
| Series | Connection | OD | Cells | Inlet&Outlet | Seal Material | Surface Finish (internal) | Surface Finish (external) | Design Pressure |
| CHDHAF= H Series Filter | J=304 | 08= 8" | 01= 8(8") | T38=TC1.5"/ for 8",12" | S=Silicone | E=Electropolished | E=Electropolished | Y=1.0Mpa |
| Housings(N6-free) | K=316L | 12 = 12" | 05= 16 | T50=TC2"/ for 16" | E=EPDM | M=Mech. Polished | M=Mech. Polished | |
| CHDHBF= H Series Filter | | 16 = 16" | 07 = 24(8") | | V=FKM | | | |
| Housings | | | 10 = 32(12",16") | | | | | |
| | | | 13 = 48(12",16") | | | | | |
| | | | 15 = 64(12",16") | | | | | |